



NOVELLE

by AISLING

LUXURY BESPOKE FURNITURE



NOVELLE

INTRODUCTION	3
AURORA	8
JASPER	20
PETERBOROUGH	28
SUTTON	40
REGENT	50
CHARLOTTE	58
YORKTON	68
DOOR SELECTOR	80
GLAZED FRAMES	81
BUILD YOUR PANTRY	82
OVERMANTLES & CANOPIES	83
HANDLES	84
PAINT PALETTE	87
FURNITURE CARE & MAINTENANCE	88



YOUR DREAM

It begins with your dream of a home featuring bespoke hand-crafted furniture so exquisite, it delights you every time you glance at it. Your kitchen should be a fundamental part of your home and your lifestyle. Beautiful, practical, functional and most of all, a unique expression of who you are and how you choose to live.

The Novelle Furniture Collection is designed to inspire and excite you and when combined with our specially sourced timbers and stunning paint finishes, you will have a kitchen that is truly original, comprising of premium quality materials and craftsmanship.



OUR PHILOSOPHY

Our craftsmen will draw on their passion for design and their artistry to create made-to-order cabinetry that will last you a lifetime. Attention to detail is the cornerstone of Novelle. Every detail is carefully considered, from the overall look of your kitchen and how it will integrate into your home, right down to the choice of hinges and handles.

OUR VALUES

From the precise selection of our timbers to the finishing details of our doors and accessories, our craftsmen know that they are delivering more than just a kitchen. We take immense pride in carefully and lovingly considering every single element of your design and because of this ethos, we truly believe that our furniture is life enhancing in every sense of the word.





EXPERTISE & SERVICE

It is the life's work of our craftsmen to meet your exacting specifications. With their incomparable level of service and skill, their quest is to satisfy your individual needs and desires, resulting in a kitchen that is unparalleled in terms of design, construction and finish. From inception to delivery, our service ensures that you are considered and cared for at every stage of the process.

MATERIALS

We only use the very finest materials in the production of our doors and accessories. Our eco-friendly timber is sourced from sustainable forests and is subject to rigorous quality testing. Top-of-the-range paint and lacquer finishes, handles, hinges and even our catches are derived from world class suppliers, ensuring that each kitchen leaving our workshop cannot be matched for quality or design.



AURORA

THE BEAUTY OF AURORA LIES IN ITS SIMPLICITY

Clean lines, emphasised by Aurora's horizontal timber grain, combined with minimalist features culminate in a contemporary dream space that will gratify even the most demanding pursuer of modern perfection.



AURORA - DEEP FOREST







Inject some striking character into the heart of your home with a dark and dramatic kitchen design. Aurora painted Deep Forest combined with graphite walls creates a refined and atmospheric feel which with the right lighting looks far from gloomy.



AURORA - DEEP FOREST



This open plan kitchen and living space features Aurora painted Light Grey, Dust Grey & Vintage Pink with build-in wall units, freestanding island and a combination of glazed frames and open shelves.



AURORA - LIGHT GREY, DUST GREY & VINTAGE PINK





AURORA - LIGHT GREY

Stunning hand-crafted walnut internals create a striking contrast to the Light Grey cabinets. Options such as coffee pod drawers or carved dovetail drawers will provide the finishing touches to your luxury coffee station.



JASPER

THE PERFECT CANVAS FOR CREATING
A SERIOUS DESIGN STATEMENT

Create countless different looks with this classic shaker kitchen. Jasper works in any setting whether it be industrial or traditional, big or small. The design possibilities are endless.



JASPER - GRAPHITE







JASPER - VIRIDIAN



Jasper painted Viridian contrasts beautifully with the White Oak display units and brass handles. This stylish design is enhanced with the dramatic framing of the fridge freezer unit which is also reflected in the stunning dresser unit with bi-fold doors.



JASPER - VIRIDIAN



PETERBOROUGH

INTRODUCE A NEW DIMENSION TO YOUR LINEAR KITCHEN DESIGN WITH THIS UNIQUE CHAMFERED FRAME

Peterborough's versatility is showcased in this modern Mexican inspired city apartment. Painted Slate Blue and contrasted with a Citrus Green island (colour match) which certainly brings this open plan space to life.



PETERBOROUGH - SLATE BLUE & CITRUS GREEN (COLOUR MATCH)







PETERBOROUGH - SLATE BLUE



A sublime example of 'old meets new', this Peterborough kitchen will attract admirers from both sides of the fence with its modern, monochromatic look, enhanced by the magnificent central island.

The Peterborough door, with its unique chamfered appearance is punctuated by various accessories ranging from a contemporary style overmantle, open shelving, crate unit drawers and inset oak chopping boards.



PETERBOROUGH - GUN METAL GREY, BRILLIANT WHITE & WHITE OAK





PETERBOROUGH - BRILLIANT WHITE AND GUN METAL GREY



SUTTON

THE STEPPED FRAME SHAKER THAT ADEPTLY SHOWS HOW
TRADITIONAL CAN MEET MODERN

With its sumptuous finish and thoughtful detailing this shaker-style door is given a new twist with a stepped frame around the centre panel. The colour palette of Dust Grey and Light Grey transfers seamlessly through the kitchen, utility and home study in this stunning modern home.



SUTTON - DUST GREY & LIGHT GREY







SUTTON - DUST GREY





SUTTON - SHELL & GUN METAL GREY

The kitchen shown here features Sutton painted Shell and Gun Metal Grey. The rich, luxurious Walnut finish used for several of the accessories contrasts exquisitely with its painted surroundings.

The painted island is embellished with a Walnut conical pedestal at one end, and barrel unit with Walnut inset chopping boards at the other end, ideally suited to bustling family life, affording plenty of added space for food preparation.

The custom-made breakfast bar is supported by solid Walnut corbals.



REGENT

AN UNDERSTATED BEADED SHAKER, REGENT LENDS ITSELF EQUALLY TO BOTH CONTEMPORARY AND CLASSIC DESIGNS

This exquisite Regent kitchen painted Willow perfectly demonstrates its versatility and beauty. The Willow cabinetry is offset with simple white walls allowing the colour to pop while complementing the natural colours of the outside space.



REGENT - WILLOW







A more contemporary example of Regent with wall units in Stone and a magnificent Forest Green island which boasts seating on two sides, door end panels and chamfered pilasters. The dresser featuring open shelving in White Oak, nestles between the tall units to add a decorative yet functional element in this modern kitchen.



REGENT - STONE & DEEP FOREST



REGENT - STONE & DEEP FOREST



CHARLOTTE

A QUINTESSENTIAL EXAMPLE OF TRULY 'GRAND' DESIGN

With its unique raised moulded beading, devised to accentuate the highlights and shadows of this ornate door, a Charlotte kitchen will never be matched for style, quality or opulence, all whilst fulfilling its practical requirements.

A sense of calming luxury is created in this Charlotte kitchen painted in Marine. Adorning a statement dresser, pastry bench, concave doors and open shelving with wine rack, it has the perfect balance of luxury while retaining versatility.



CHARLOTTE - MARINE







CHARLOTTE - CASHMERE

This beautiful Charlotte kitchen painted Cashmere includes an elegant island featuring curved doors and integrated seating. The Oak chopping board and tray units, sloped internal dovetail drawers, coffee station and stunning walk-in pantry demonstrate the perfect fusion of design and functionality.



CHARLOTTE - CASHMERE





CHARLOTTE - CASHMERE



YORKTON

A SOLID SENSE OF STYLE WITH ORNATE DOOR DETAILING
EVOKING A TRUE HANDCRAFTED FEEL

This Yorkton kitchen offers elegance and charm with its meticulous detailing and stylish design, enhanced here through a combination of Taupe Grey and White Oak cabinetry. High cornices, fluted pilasters, brass hardware and the dramatic backsplash work perfectly together to create a real sense of opulence.



YORKTON - TAUPE GREY & WHITE OAK







YORKTON - HERITAGE GREEN & SLATE BLUE



YORKTON - HERITAGE GREEN & SLATE BLUE



When it comes to creating a truly exceptional kitchen you need to go beyond the obvious. Here the Yorkton kitchen sits effortlessly in a traditional period home with plenty of space for entertaining family and friends.

Wall units are painted Heritage Green and are contrasted with Slate Blue on the elegantly curved island and spacious bootroom, which incorporates a special place for the family pooch. The fridge and larder stand either side of a glazed dresser with ornate Gothic frames.





WALNUT PANTRY

Top A: Wine Rack

Bottom A: 3 Pan Drawers

Pantry Spice Racks



MAKE IT YOUR OWN

Choosing the finer details are what takes a simple kitchen plan and transforms it into your personal living space.

Carefully select your perfect door style and colour combinations. Finish it off with a handle that looks and feels amazing. You will know when you have made the right choice when you get that overwhelming sense of excitement - you have fallen in love!

DOOR SELECTOR

AURORA



WHITE OAK

DUST GREY
(PAINTED GRAIN FINISH)

CHARLOTTE



WHITE OAK

CARDAMOM
(PAINTED GRAIN FINISH)

JASPER



WHITE OAK

MARINE
(PAINTED GRAIN FINISH)

PETERBOROUGH



WHITE OAK

STONE
(PAINTED GRAIN FINISH)

REGENT



WHITE OAK

VIRIDIAN
(PAINTED GRAIN FINISH)

SUTTON



WHITE OAK

HERITAGE GREEN
(PAINTED GRAIN FINISH)

YORKTON



WHITE OAK

LIGHT GREY
(PAINTED GRAIN FINISH)

GLAZED FRAMES

Choose the perfect glazed doors to enhance your wall and dresser units.



PLAIN FRAME



PLAIN FEATURE FRAME



FEATURE FRAME



GEORGIAN FRAME A



GEORGIAN FRAME B



GOTHIC



DAMASCUS

BUILD YOUR PANTRY

Create the perfect pantry by selecting your preferred unit for each section.

TOP



Wine Rack



Glass Holder



Shaped Open Shelves

BOTTOM

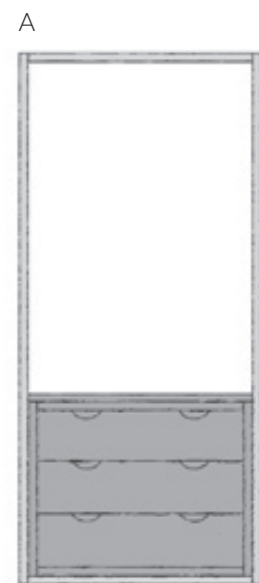

3 Drawers (1 aperture)

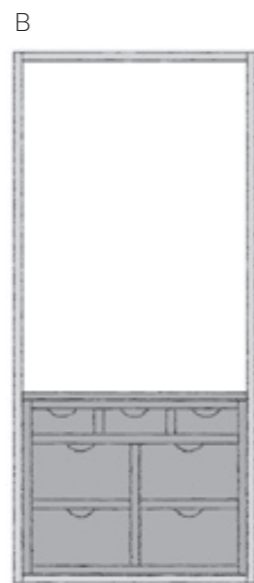

7 Drawers (7 apertures)



5 Drawers (5 apertures)

OVERMANTLES & CANOPIES

Make a statement with one of our stunning overmantles or canopies.

OVERMANTLES

OVERMANTLE 0275P

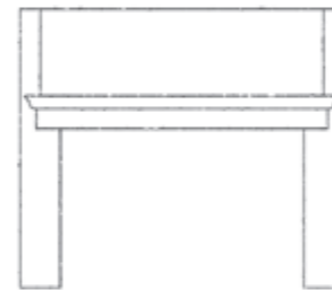

OVERMANTLE 0276S

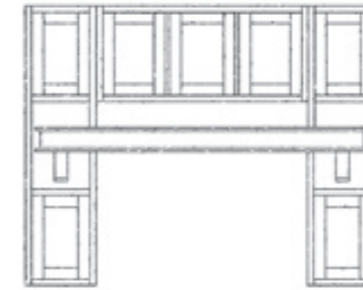

OVERMANTLE 0277Y

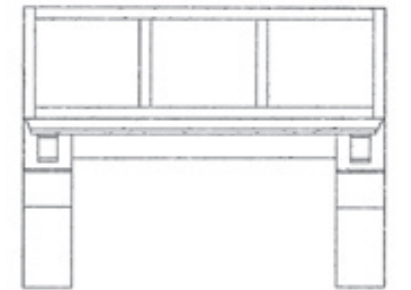

CANOPIES

CANOPY 0191C

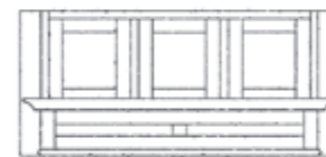

CANOPY 0105E

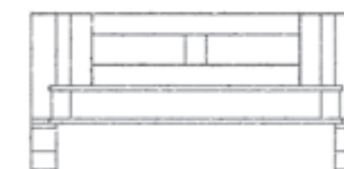

CANOPY 0106P



CANOPY 0181Q



HANDLES

Your personal choice of handles can transform the look and feel of your living space.
Select the design, finish and size that adds the perfect finishing touch to your dream kitchen.

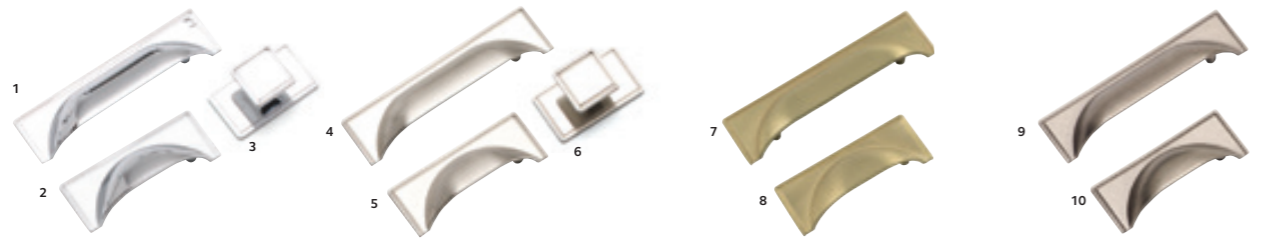

1 CHROME CUP HANDLE: AN-175
2 CHROME CUP HANDLE: AN-172
3 CHROME KNOB: AN-180
4 BRUSHED NICKEL CUP HANDLE: AN-174
5 BRUSHED NICKEL CUP HANDLE: AN-171
6 BRUSHED NICKEL KNOB: AN-179
7 BRASS CUP HANDLE: AN-320
8 BRASS CUP HANDLE: AN-319
9 PEWTER CUP HANDLE: AN-176
10 PEWTER CUP HANDLE: AN-173



11 CHROME CUP HANDLE: AN-315
12 CHROME D-HANDLE: AN-316
13 CHROME KNOB: AN-169
14 BRUSHED NICKEL CUP HANDLE: AN-272
15 BRUSHED NICKEL D-HANDLE: AN-266
16 BRUSHED NICKEL KNOB: AN-269
17 SATIN BRASS CUP HANDLE: AN-270
18 SATIN BRASS D-HANDLE: AN-264
19 SATIN BRASS KNOB: AN-267
20 ANTIQUE COPPER CUP HANDLE: AN-271
21 ANTIQUE COPPER D-HANDLE: AN-265
22 ANTIQUE COPPER KNOB: AN-268



23 POLISHED NICKEL CUP HANDLE: AN-156
24 POLISHED NICKEL BOW HANDLE: AN-153
25 POLISHED NICKEL KNOB: AN-159
26 PEWTER CUP HANDLE: AN-157
27 PEWTER BOW HANDLE: AN-154
28 PEWTER NICKEL KNOB: AN-160
29 BRUSHED SATIN BRASS CUP HANDLE: AN-302
30 BRUSHED SATIN BRASS BOW HANDLE: AN-303
31 BRUSHED SATIN BRASS KNOB: AN-301
32 AMERICAN COPPER CUP HANDLE: AN-155
33 AMERICAN COPPER BOW HANDLE: AN-152
34 AMERICAN COPPER KNOB: AN-158



35 CHROME CUP HANDLE: AN-311
36 CHROME D-HANDLE: AN-310
37 CHROME KNOB: AN-309
38 BRUSHED SATIN NICKEL CUP HANDLE: AN-308
39 BRUSHED SATIN NICKEL D-HANDLE: AN-307
40 BRUSHED SATIN NICKEL KNOB: AN-306
41 SATIN NICKEL CUP HANDLE: AN-255
42 SATIN NICKEL D-HANDLE: AN-259
43 SATIN NICKEL KNOB: AN-257
44 BLACK NICKEL CUP HANDLE: AN-256
45 BLACK NICKEL D-HANDLE: AN-260
46 BLACK NICKEL KNOB: AN-258

HANDLES



47 POLISHED NICKEL CUP HANDLE: AN-195
48 POLISHED NICKEL KNOB: AN-198
49 BRUSHED SATIN NICKEL CUP HANDLE: AN-197
50 BRUSHED SATIN NICKEL KNOB: AN-200
51 BRUSHED SATIN BRASS CUP HANDLE: AN-304
52 BRUSHED SATIN BRASS KNOB: AN-305
53 AMERICAN COPPER CUP HANDLE: AN-196
54 AMERICAN COPPER KNOB: AN-199

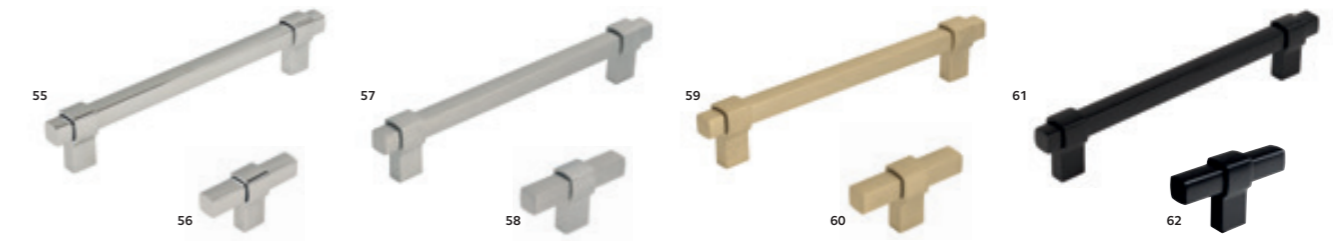

55 CHROME BAR HANDLE: AN-379
56 CHROME T-BAR AN-378
57 BRUSHED NICKEL BAR HANDLE: AN-385
58 BRUSHED NICKEL T-BAR AN-384
59 BRUSHED BRASS BAR HANDLE: AN-381
60 BRUSHED BRASS T-BAR AN-380
61 MATTE BLACK BAR HANDLE: AN-383
62 MATTE BLACK T-BAR AN-382



63 BRUSHED NICKEL BAR HANDLE: AN-370
64 BRUSHED NICKEL T-BAR AN-369
65 ANTIQUE BRASS BAR HANDLE: AN-364
66 ANTIQUE BRASS T-BAR AN-363
67 MATTE BLACK BAR HANDLE: AN-367
68 MATTE BLACK T-BAR AN-366
69 BRIGHT CHROME KNOB: AN-207
70 INOX LOOK KNOB: AN-209
71 ANTIQUE BROWN KNOB: AN-208
72 MATTE BLACK KNOB: AN-210



73 BRUSHED NICKEL BAR HANDLE: AN-377
74 BRUSHED NICKEL T-BAR AN-376
75 ANTIQUE BRASS BAR HANDLE: AN-373
76 ANTIQUE BRASS T-BAR AN-372
77 MATTE BLACK BAR HANDLE: AN-375
78 MATTE BLACK T-BAR AN-374
79 BRUSHED NICKEL D-HANDLE: AN-388
80 BRUSHED BRASS D-HANDLE: AN-386
81 MATTE BLACK D-HANDLE: AN-387

HANDLES



82 ANTIQUE BRASS BAR HANDLE: AN-328
 83 ANTIQUE BRASS T-BAR AN-327
 84 MATTE BLACK BAR HANDLE: AN-331
 85 MATTE BLACK T-BAR AN-330
 86 BRIGHT NICKEL SQUARE CUP AN-357
 87 ANTIQUE BRASS SQUARE CUP AN-359
 88 MATTE BLACK SQUARE CUP AN-361
 89 BRIGHT NICKEL D-HANDLE: AN-358
 90 ANTIQUE BRASS D-HANDLE: AN-360
 91 MATTE BLACK D-HANDLE: AN-362

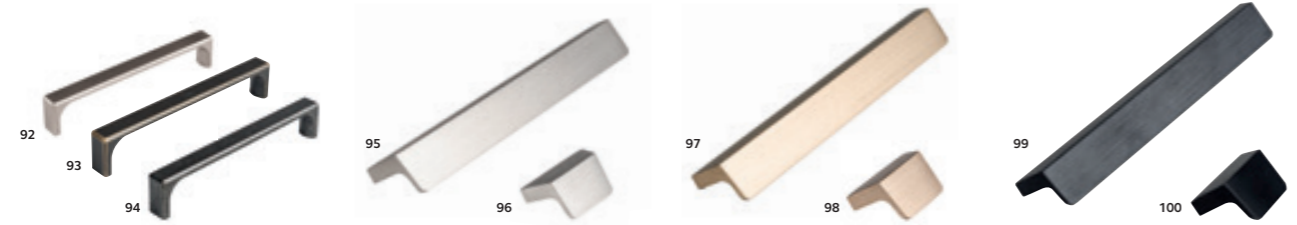

92 INOX D-HANDLE: AN-350
 93 ANTIQUE BRASS D-HANDLE: AN-349
 94 ANTIQUE GREY D-HANDLE: AN-348
 95 BRUSHED INOX TRIM HANDLE: AN-336
 96 BRUSHED INOX TRIM KNOB: AN-335
 97 BRUSHED BRASS TRIM HANDLE: AN-334
 98 BRUSHED BRASS TRIM KNOB: AN-333
 99 BRUSHED BLACK TRIM HANDLE: AN-338
 100 BRUSHED BLACK TRIM KNOB: AN-337

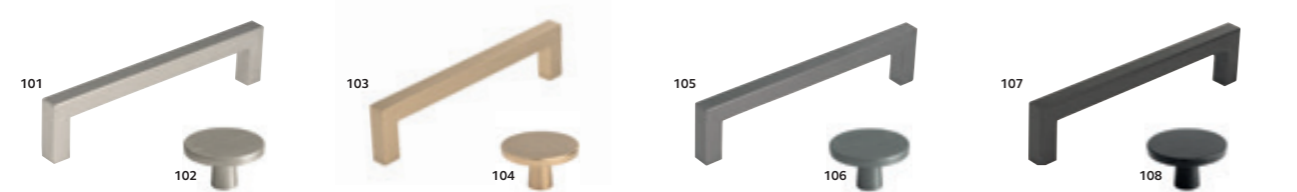

101 BRUSHED INOX LOOK D-HANDLE: AN-278
 102 BRUSHED INOX LOOK KNOB: AN-274
 103 BRUSHED BRASS D-HANDLE: AN-277
 104 BRUSHED BRASS KNOB: AN-273
 105 BRUSHED ANTHRACITE D-HANDLE: AN-279
 106 BRUSHED ANTHRACITE KNOB: AN-275
 107 BRUSHED BLACK D-HANDLE: AN-280
 108 BRUSHED BLACK KNOB: AN-276

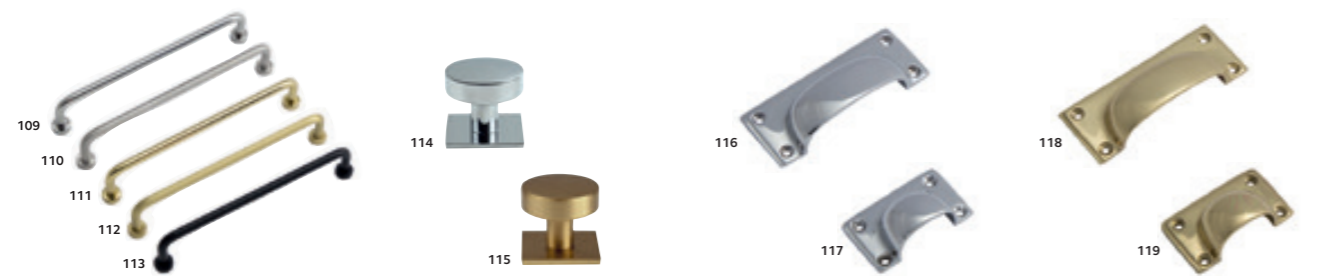

109 MIRROR POLISHED D-HANDLE: AN-202
 110 SILK POLISHED D-HANDLE: AN-204
 111 POLISHED BRASS D-HANDLE: AN-205
 112 BRUSHED BRASS D-HANDLE: AN-203
 113 MATTE BLACK D-HANDLE: AN-206
 114 CHROME KNOB: AN-312
 115 BRUSHED SATIN BRASS KNOB: AN-313
 116 BRUSHED NICKEL CUP HANDLE: AN-191
 117 BRUSHED NICKEL CUP HANDLE: AN-193
 118 POLISHED BRASS CUP HANDLE: AN-192
 119 POLISHED BRASS CUP HANDLE: AN-194

PAINT PALETTE

Choose from our standard palette of 30 house-blended colours or opt for a bespoke colour using our Colour Match Service.

WHITES/CREAMS	BEIGES	GREYS
Brilliant White	Shell	Light Grey
Porcelain	Taupe Grey	Dust Grey
White Cotton	Mussel	Gun Metal Grey
	Stone	Graphite
	Stone Grey	
	Lava	
BLUES	GREENS	PINKS/PURPLES
Pantry Blue	Light Teal	Cashmere
Airforce	Viridian	Vintage Pink
Parisian Blue	Sage Green	Lavender Grey
Marine	Cardamom	Deep Heather
Slate Blue	Willow	
Indigo	Heritage Green	
	Deep Forest	

FURNITURE CARE & MAINTENANCE

PRE-INSTALLATION RECOMMENDATIONS

Ensure that all new-builds or newly plastered rooms have been left to environmentally stabilise prior to the installation of new kitchen doors. Kitchen doors must not be installed into a damp or moisture-rich environment as it will cause undesirable movement in the joints and panels of the door.

LIGHT

Timber changes colour when it is exposed to light. The species of timber and intensity of exposure will affect the rate of change. Due to this we recommend that timber samples displayed in showrooms be changed regularly. It is advised that colour change is also taken into consideration when fitting new or replacement doors to an existing kitchen some time after the original kitchen was installed.

CLEANING

- do not use wax-furniture polish, abrasive or aggressive cleaners, bleach or other hypochlorite (chlorine) based cleaners, multi-purpose cleaners, dilutes, acetone alcohol, solvent or similar products on any door, as this will damage the surface;
- only use a 5% soap, 95% water (liquid soap) solution, wiping with a damp (not wet) cloth, finally drying with a soft clean cloth only.
- ensure all cooking splashes are wiped immediately with a damp cloth;
- dust with a soft cloth only.

MOISTURE

Excess moisture can damage a timber product - it is recommended that susceptible areas such as around the sink are thoroughly maintained and kept dry at all times.

This brochure is intended only as a guide to Novelle products and, as no picture can accurately convey the true beauty and outstanding quality of our furniture, it is suggested that you visit a Novelle retailer to examine the product personally before purchase. Only then can you appreciate the detail bestowed upon each and every component, the rich, sumptuous finishes applied and the superior quality craftsmanship that is lovingly ingrained into each piece.

Whilst some of our products are made wholly from natural materials, a number are also made (in whole or part) from man-made materials, as they can be more durable, flexible and/or practical than natural products. Our retailers will be happy to discuss all details of the materials used in the production of our furniture so that you are fully aware of how and why they were selected.

Most of the images used in this brochure are representative of Novelle furniture designs but there may be variations in colour, design and function. As we strive to continuously improve all our products on a consistent basis, we accordingly reserve the right to change and update products without notice. All copyright, design right, registered design and other intellectual property rights in our designs and products featured in this brochure are, and remain, our property and unauthorised use of any of our intellectual property rights is strictly prohibited. Appropriate action will be taken against any infringement of our intellectual property rights.



NOVELLEFURNITURE.COM